



Fiona O'Dwyer, *Down the Mountain* series, b/w photograph,

## Fiona O'Dwyer

### *I Went Up the Mountain With Someone Else's Story and Came Down With My Own*

Limerick City Gallery of Art (LCGA) is delighted to announce details of Fiona O' Dwyer's first solo exhibition in the Gallery. O' Dwyer is a graduate of Limerick School of Art and Design and lives in North Clare.

This exhibition sees O'Dwyer using carefully selected materials including ink, copper alloys, liquid light and raw pigment to create an intricate body of sculpture, drawing, photography and video works. The Trace series of drawings for example are made from layers of paper, pencil and compressed earth while the Hurt sculptures are made using casting methods of the Bronze Age.

This work follows from many years exploring ideas around familial memory. At its heart is an account by the artist's father of his experience of picking hurts in the woodlands and mountain slopes of Tipperary as a source of income in the 1950's. These wild blueberries came to embody particular ideas for the artist but in the end it is important for her that in the making the works become their own thing.

"It is all in the making, in the materials, in the blood. I pick the hurts. I take a cast and fill the mould with wax. I encase the wax in dung, clay and sand and fire it. I tend the fire and melt the bronze then pour the molten metal. I open the moulds and pick some and discard some. I clean. I wait...and start again."

A fully illustrated publication will accompany this exhibition with an essay by Michaela Cutaya and will be available end of August.

**Running 21 June – 25 August 2019**

Carnegie Building, Pery Square, Limerick, Ireland.

**FREE ADMISSION**

Tel: +353(0)61 310633; F:+353(0)61 310228; Email: [artgallery@limerick.ie](mailto:artgallery@limerick.ie); Web [www.gallery.limerick.ie](http://www.gallery.limerick.ie)

Opening Hours: Monday/Tuesday/Wednesday/Friday & Saturday 10-5.30pm; Thursday 10-8pm; Sunday 12-5.30.

**LAST ENTRY 5 & 7.30pm**      **Closed on Public & Bank Holidays.**

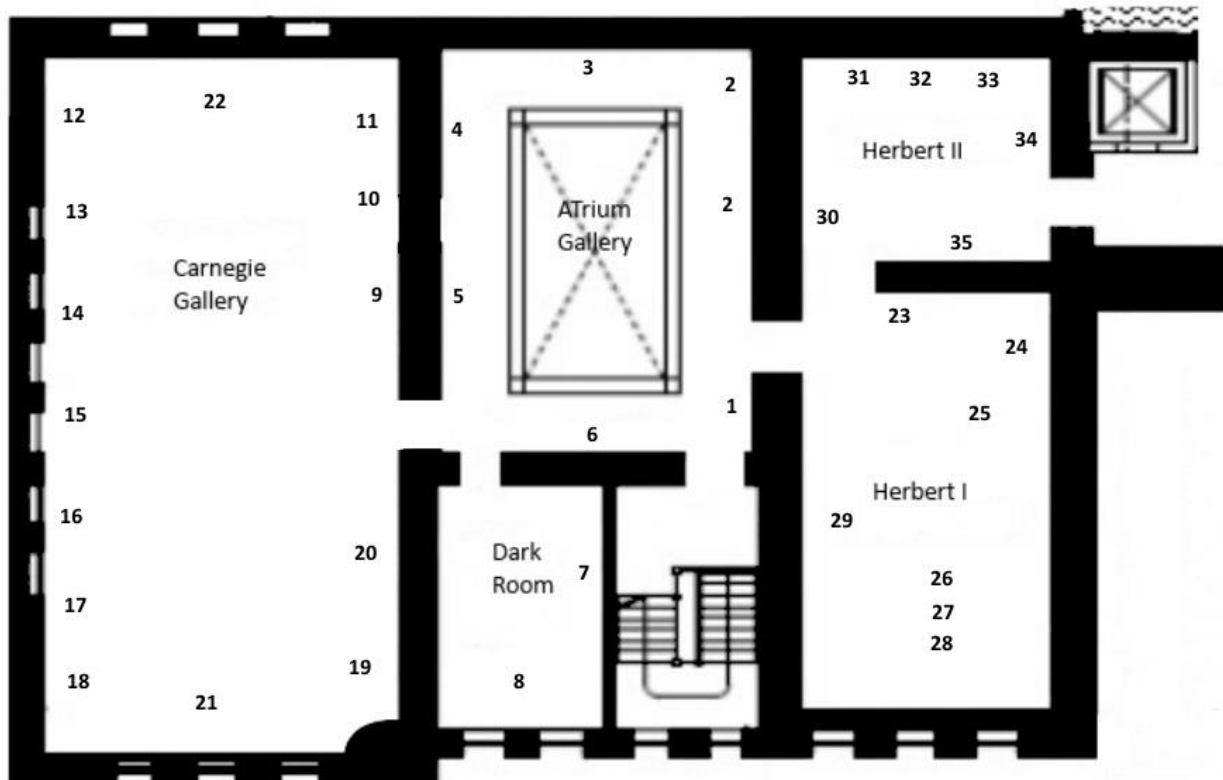

	Title	year	medium	size
1. (i)	your breath	2015-2019	Ink, pencil and pollen on paper Hahnemühle watercolour paper	20.5 x 14.8cm
1. (ii)	my breath	2015-2019	Ink, pencil and pollen on paper Hahnemühle watercolour paper	20.5 x 14.8cm
2.(i)	Between the Mountain and Me + Between Me and the Mountain 1	2016	Ink, pencil, raw pigment and medium on Hahnemühle watercolour paper	14 x .9cm
2. (ii)	Between the Mountain and Me + Between Me and the Mountain 2	2016	Ink, pencil, raw pigment and medium on Hahnemühle watercolour paper	14 x .9cm
2. (iii)	Between the Mountain and Me + Between Me and the Mountain 3	2016	Ink, pencil, raw pigment and medium on Hahnemühle watercolour paper	14 x .9cm
2. (iv)	Between the Mountain and Me + Between Me and the Mountain 4	2016	Ink, pencil, raw pigment and medium on Hahnemühle watercolour paper	14 x .9cm
2. (v)	Between the Mountain and Me + Between Me and the Mountain 5	2016	Ink, pencil, raw pigment and medium on Hahnemühle watercolour paper	14 x .9cm

Carnegie Building, Pery Square, Limerick, Ireland.

**FREE ADMISSION**

Tel: +353(0)61 310633; F:+353(0)61 310228; Email: [artgallery@limerick.ie](mailto:artgallery@limerick.ie); Web [www.gallery.limerick.ie](http://www.gallery.limerick.ie)

Opening Hours: Monday/Tuesday/Wednesday/Friday & Saturday 10-5.30pm; Thursday 10-8pm; Sunday 12-5.30.

**LAST ENTRY 5 & 7.30pm** Closed on Public & Bank Holidays.



2. (vi)	<b>Between the Mountain and Me + Between Me and the Mountain 6</b>	2016	Ink, pencil, raw pigment and medium on Hahnemühle watercolour paper	14 x .9cm
2. (vii)	<b>Between the Mountain and Me + Between Me and the Mountain 7</b>	2016	Ink, pencil, raw pigment and medium on Hahnemühle watercolour paper	14 x .9cm
2. (viii)	<b>Between the Mountain and Me + Between Me and the Mountain 8</b>	2016	Ink, pencil, raw pigment and medium on Hahnemühle watercolour paper	14 x .9cm
2. (ix)	<b>Between the Mountain and Me + Between Me and the Mountain 9</b>	2016	Ink, pencil, raw pigment and medium on Hahnemühle watercolour paper	14 x .9cm
2. (x)	<b>Between the Mountain and Me + Between Me and the Mountain 10</b>	2016	Ink, pencil, raw pigment and medium on Hahnemühle watercolour paper	14 x .9cm
2.(xi)	<b>Between the Mountain and Me + Between Me and the Mountain 11</b>	2016	Ink, pencil, raw pigment and medium on Hahnemühle watercolour paper	14 x .9cm
2. (xii)	<b>Between the Mountain and Me + Between Me and the Mountain 12</b>	2016	Ink, pencil, raw pigment and medium on Hahnemühle watercolour paper	14 x .9cm
2. (xiii)	<b>Between the Mountain and Me + Between Me and the Mountain 13</b>	2016	Ink, pencil, raw pigment and medium on Hahnemühle watercolour paper	14 x .9cm
3.(i)	<b>berry tree</b>	2015-2019	Ink, pencil and pollen on paper Hahnemühle watercolour paper	20.5 x 14.8cm
3.(ii)	<b>wooden singing room</b>	2015-2019	Ink, pencil and pollen on paper Hahnemühle watercolour paper	20.5 x 14.8cm
3.(iii)	<b>walking opera hotel</b>	2015-2019	Ink, pencil and pollen on paper Hahnemühle watercolour paper	20.5 x 14.8cm
3.(iv)	<b>reek</b>	2015-2019	Ink, pencil and pollen on paper Hahnemühle watercolour paper	20.5 x 14.8cm
3.(v)	<b>mother knows best</b>	2015-2019	Ink, pencil and pollen on paper Hahnemühle watercolour paper	20.5 x 14.8cm
4. (i)	<b>red siphon field</b>	2015-2019	Ink, pencil and pollen on paper Hahnemühle watercolour paper	20.5 x 14.8cm
4. (ii)	<b>walk down home</b>	2015-2019	Ink, pencil and pollen on paper Hahnemühle watercolour paper	20.5 x 14.8cm
4.(iii)	<b>reek + net</b>	2015-2019	Ink, pencil and pollen on paper Hahnemühle watercolour paper	20.5 x 14.8cm
5. (i)	<b>family</b>	2015-2019	Ink, pencil and pollen on paper Hahnemühle watercolour paper	20.5 x 14.8cm
5. (ii)	<b>family III</b>	2015-2019	Ink, pencil and pollen on paper Hahnemühle watercolour paper	20.5 x 14.8cm
5. (iii)	<b>family V</b>	2015-2019	Ink, pencil and pollen on paper Hahnemühle watercolour paper	20.5 x 14.8cm

Carnegie Building, Pery Square, Limerick, Ireland.

**FREE ADMISSION**

Tel: +353(0)61 310633; F:+353(0)61 310228; Email: [artgallery@limerick.ie](mailto:artgallery@limerick.ie); Web [www.gallery.limerick.ie](http://www.gallery.limerick.ie)

Opening Hours: Monday/Tuesday/Wednesday/Friday & Saturday 10-5.30pm; Thursday 10-8pm; Sunday 12-5.30.

**LAST ENTRY 5 & 7.30pm** Closed on Public & Bank Holidays.



5. (iv)	family II	2015-2019	Ink, pencil and pollen on paper Hahnemühle watercolour paper	20.5 x 14.8cm
5. (v)	family IV	2015-2019	Ink, pencil and pollen on paper Hahnemühle watercolour paper	20.5 x 14.8cm
5. (vi)	family VI	2015-2019	Ink, pencil and pollen on paper Hahnemühle watercolour paper	20.5 x 14.8cm
6. (i)	empty	2015-2019	Ink, pencil and pollen on paper Hahnemühle watercolour paper	20.5 x 14.8cm
6. (ii)	blue tin can	2015-2019	Ink, pencil and pollen on paper Hahnemühle watercolour paper	20.5 x 14.8cm
6. (iii)	tin can yellow cloth	2015-2019	Ink, pencil and pollen on paper Hahnemühle watercolour paper	20.5 x 14.8cm
6. (iv)	as map and clock	2015-2019	Ink, pencil and pollen on paper Hahnemühle watercolour paper	20.5 x 14.8cm
6. (v)	7 roads out	2015-2019	Ink, pencil and pollen on paper Hahnemühle watercolour paper	20.5 x 14.8cm
7	Hurt - Dark room		Projection	variable dimensions
8	Sold By Weight - ii Dark room	2018 - 2019	28 bronze sculptures/oak and perspex	
9	sand obscura (red table drawing series)	2016-2019	Raw pigment, rabbit skin glue, ink and pencil on stretched Fabriano paper	100 x 70cm
10	fur umbrella	2016-2019	Raw pigment, rabbit skin glue, ink and pencil on stretched Fabriano paper	100 x 70cm
11	assumption christ the king sacred heart	2016-2019	Raw pigment, rabbit skin glue, ink and pencil on stretched Fabriano paper	100 x 70cm
12	pink raglan sleeved life cardigan for light hurt berry	2016-2019	Raw pigment, rabbit skin glue, ink and pencil on stretched Fabriano paper	100 x 70cm
13	the ghost that took my fathers hand	2016-2019	Raw pigment, rabbit skin glue, ink and pencil on stretched Fabriano paper	100 x 70cm
14	tights + rabbit pillowcase	2016-2019	Raw pigment, rabbit skin glue, ink and pencil on stretched Fabriano paper	100 x 70cm
15	pearls can + ash	2016-2019	Raw pigment, rabbit skin glue, ink and pencil on stretched Fabriano paper	100 x 70cm
16	hurt tea fountain	2016-2019	Raw pigment, rabbit skin glue, ink and pencil on stretched Fabriano paper	100 x 70cm

Carnegie Building, Pery Square, Limerick, Ireland.

**FREE ADMISSION**

Tel: +353(0)61 310633; F:+353(0)61 310228; Email: [artgallery@limerick.ie](mailto:artgallery@limerick.ie); Web [www.gallery.limerick.ie](http://www.gallery.limerick.ie)

Opening Hours: Monday/Tuesday/Wednesday/Friday & Saturday 10-5.30pm; Thursday 10-8pm; Sunday 12-5.30.

**LAST ENTRY 5 & 7.30pm** Closed on Public & Bank Holidays.



17	red silk skirt tin gallon sweet can blue scarf	2016–2019	Raw pigment, rabbit skin glue, ink and pencil on stretched Fabriano paper	100 x 70cm
18	the last light	2016–2019	Raw pigment, rabbit skin glue, ink and pencil on stretched Fabriano paper	100 x 70cm
19	bleeding double cross	2016–2019	Raw pigment, rabbit skin glue, ink and pencil on stretched Fabriano paper	100 x 70cm
20	delux tea-o-matic pifco teas-made	2016–2019	Raw pigment, rabbit skin glue, ink and pencil on stretched Fabriano paper	100 x 70cm
21	Annunciation / Christ The King / St. Michael Carnegie	2016	Cast bronze bells, (set of 3), oak and Perspex plinth, & table	56 x 93 x 31 cm
22	Sold By Weight	2018 - 2019	39 bronze sculptures/oak and perspex	
23	Mother Knows Best II	2018	Photographic prints using liquid light on Fabriano watercolour paper	50 x 35cm
24	Mother Knows Best I	2018	Photographic prints using liquid light on Fabriano watercolour paper	50 x 35cm
25	Trace 3 + - Raglan mountain scar	2013-2016	Earth, pencil, Hahnemühle etching paper, tracing paper, perspex and oak stand.	72 x 86 x 58cm
26	Trace 4 + I start to draw ...	2013-2016	Earth, pencil, Hahnemühle etching paper, tracing paper, perspex and oak stand.	72 x 86 x 58cm
27	Trace 2 + - I wiped it away	2013-2016	Earth, pencil, Hahnemühle etching paper, tracing paper, perspex and oak stand.	72 x 86 x 58cm
28	Trace 2 - I am drawing ...	2013-2016	Earth, pencil, Hahnemühle etching paper, tracing paper, perspex and oak stand.	72 x 86 x 58cm
29	Trace 3 - I join a flying column	2013-2016	Earth, pencil, Hahnemühle etching paper, tracing paper, perspex and oak stand.	72 x 86 x 58cm
30	Heart Sound Point 5	2017–2018	Digital Prints on Inkjet paper	120 cm x 60 cm
31	Heart Sound Point 2	2017–2018	Digital Prints on Inkjet paper	120 cm x 60 cm
32	Heart Sound Point 1	2017–2018	Digital Prints on Inkjet paper	120 cm x 60 cm
33	Heart Sound Point 3	2017–2018	Digital Prints on Inkjet paper	120 cm x 60 cm
34	Heart Sound Point 4	2017–2018	Digital Prints on Inkjet paper	120 cm x 60 cm
35	whole skirt hoop Herbert 2	2016	Ink, pencil, raw pigment and medium on Fabriano watercolour paper	100 x 70 cm

Carnegie Building, Pery Square, Limerick, Ireland.

**FREE ADMISSION**

Tel: +353(0)61 310633; F:+353(0)61 310228; Email: [artgallery@limerick.ie](mailto:artgallery@limerick.ie); Web [www.gallery.limerick.ie](http://www.gallery.limerick.ie)

Opening Hours: Monday/Tuesday/Wednesday/Friday & Saturday 10-5.30pm; Thursday 10-8pm; Sunday 12-5.30.

**LAST ENTRY 5 & 7.30pm** Closed on Public & Bank Holidays.



### Drawings Text

#### I try to avoid {drawing} traps as I follow the light

I draw a boundary through the window

I have been trying to look at the paper with natural light for days so I can be sure when I start

I hope the light will also stop damp

I draw a boundary tree and nettles

I walk to the corner and walk back and draw a corner

I move out of the corner following the light on the page as it moves

I realize this is what the drawing is about and it becomes it

I started it but the drawing knows itself

#### Whole skirt hoop structure

My Elizabeth

I think of another Elizabeth whose feet are in the iconic photo

her feet and the hem of her skirt

This flows from waist to hem – seeping out

I think this only as I reflect on it in a {mostly} visual reading

I feel is physically as a lateral movement

What [ should it be

[ if it was to soak up through the hem from the earth

#### Cardigan

I keep it [ as a warning

[ as itself

I keep it around

#### Raglan/ MS

Freed by the previous

Dots direct me

I feel my shoulder from inside Blood

It is a drawing of moving, an unbroken drawing

#### Siphon field

Sure mike stand as the crow flew

Carnegie Building, Pery Square, Limerick, Ireland.

**FREE ADMISSION**

Tel: +353(0)61 310633; F:+353(0)61 310228; Email: [artgallery@limerick.ie](mailto:artgallery@limerick.ie); Web [www.gallery.limerick.ie](http://www.gallery.limerick.ie)

Opening Hours: Monday/Tuesday/Wednesday/Friday & Saturday 10-5.30pm; Thursday 10-8pm; Sunday 12-5.30.

**LAST ENTRY 5 & 7.30pm** *Closed on Public & Bank Holidays.*



White silk field

Taken from the bán

Trace 2

I am drawing ... I smell  
sulphur sweat and gas  
No thing can be separated out and stuff remains  
I can hear a voice  
deep, cavernous, light and curling like a song  
Sound is round here too

Trace 2 +

I wiped it away quite roughly, thinking it would reveal It took a while and someone else to see  
Then I saw stars and crosses and a wounded heart

Trace 3

I join a flying column in twenty and sixteen  
House with roots and a path across the Galtees

Trace 3 +

Raglan mountain wound Amazon

Trace 4

Field to mountain I will wait for the light This is winter light

Trace 4 +

I start to draw ... first emerges a house then in the next line a field  
I am glad because planning can kill



Comhairle Contae Thiobraid Árann  
Tipperary County Council



COMHAIRLE | CLARE  
CONTAE AN CHLÁIR | COUNTY COUNCIL

Carnegie Building, Pery Square, Limerick, Ireland.

**FREE ADMISSION**

Tel: +353(0)61 310633; F:+353(0)61 310228; Email: [artgallery@limerick.ie](mailto:artgallery@limerick.ie); Web [www.gallery.limerick.ie](http://www.gallery.limerick.ie)

Opening Hours: Monday/Tuesday/Wednesday/Friday & Saturday 10-5.30pm; Thursday 10-8pm; Sunday 12-5.30.

**LAST ENTRY 5 & 7.30pm** *Closed on Public & Bank Holidays.*



Comhairle Cathrach  
& Contae Luimnigh  
**Limerick City**  
& County Council

